

vtech[®]

Instruction Manual



FIRE ENGINE RESCUE



VTech understands that a child's needs and abilities change as they grow and with that in mind we develop our toys to teach and entertain at just the right level...

Electronic Learning Computers

Cool, aspirational and inspiring computers for curriculum related learning

I need...

...challenging activities that can keep pace with my growing mind

...intelligent technology that adapts to my level of learning

...National Curriculum based content to support what I'm learning at school

Pre-School

Interactive toys to develop their imagination and encourage language development

I want...

...to get ready for school by starting to learn the alphabet and counting

...my learning to be as fun, easy and exciting as can be

...to show my creativity with drawing and music so my whole brain develops

vtech Baby

Toys that will stimulate their interest in different textures, sounds and colours

I am...

...responding to colours, sounds and textures

...understanding cause and effect

...learning to touch, reach, grasp, sit-up, crawl and toddle

Birth-36 months



3-6 years



4-10 years



To learn more about this and other VTech® products, visit www.vtech.co.uk

INTRODUCTION

Makers start your creativity engines! Build and colour your very own racetrack using the included track and get ready to race! Place the dynamic fire engine on top of the tracks and watch it race to the rescue - let's save the day!

WARNING: All packing materials such as tape, plastic sheets, packaging locks, removable tags, cable ties, cords and packaging screws are not part of this toy and should be discarded for your child's safety.

NOTE: Please keep this Instruction Manual as it contains important information.

ASSEMBLY INSTRUCTIONS

With the **Car-Board Racers™ Fire Engine Rescue**, safety comes first. Adult assembly required. For your child's safety, do not let them play with this toy until the initial assembly steps are completed. See the colour manual for initial assembly instructions.

NOTE:

If it is found that the fire ladder or fire nozzle has fallen, please assemble it according to the following steps:

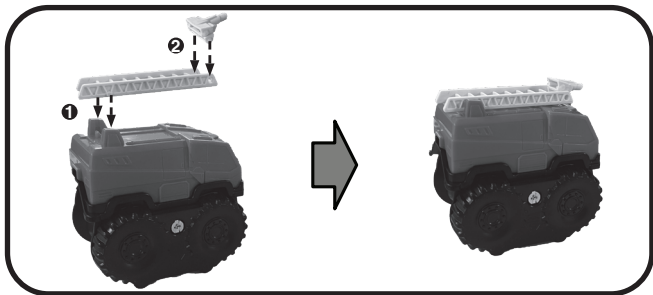

IMPORTANT NOTES

1. For your child's safety, do not put the vehicle on your clothing, body or hair.

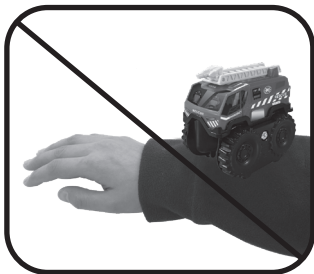

2. If the fire engine is not running on the cardboard smoothly or falls off the track, please try the following:
 - 2.1 Adjust the curvature of the cardboard to prevent sharp angles.
 - 2.2 Adjust the position of the stands to allow the top edges of the tracks to align.
 - 2.3 Trim away the damaged part of the cardboard and connect the cardboard firmly again.
 - 2.4 Replace the cardboard by tracing and cutting out a new track piece. For best results, use cardboard between 6mm and 8mm in thickness.
3. Keep the cardboard track pieces in a dry place.

BATTERY REMOVAL AND INSTALLATION

1. Make sure the unit is turned **Off**.
2. Find the battery cover located on the wheels on each side, use a screwdriver to loosen the screw and then open the battery cover.
3. Remove the old battery by pulling up on one end of the battery.
4. Install 1 new AA (LR6/AM-3) battery following the diagram inside the battery box. (For best performance, alkaline batteries or fully charged Ni-MH rechargeable batteries are recommended.)
5. Replace the battery cover and tighten the screw to secure.
6. Do the same installation on the other side of the vehicle.

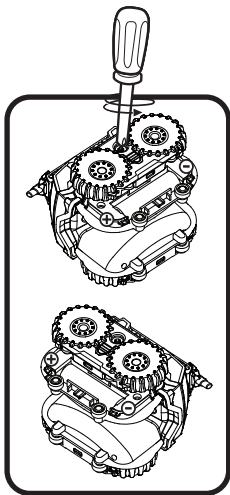

WARNING:

Adult assembly required for battery installation.
Keep batteries out of reach of children.

IMPORTANT: BATTERY INFORMATION

- Insert batteries with the correct polarity (+ and -).
- Do not mix old and new batteries.
- Do not mix alkaline, standard (carbon-zinc) or rechargeable batteries.
- Only batteries of the same or equivalent type as recommended are to be used.
- Do not short-circuit the supply terminals.
- Remove batteries during long periods of non-use.
- Remove exhausted batteries from the toy.
- Dispose of batteries safely. Do not dispose of batteries in fire.

RECHARGEABLE BATTERIES:

- Remove rechargeable batteries (if removable) from the toy before charging.
- Rechargeable batteries are only to be charged under adult supervision.
- Do not charge non-rechargeable batteries.

Disposal of batteries and product



The crossed-out wheeled bin symbols on products and batteries, or on their respective packaging, indicates they must not be disposed of in domestic waste as they contain substances that can be damaging to the environment and human health.



The chemical symbols Hg, Cd or Pb, where marked, indicate that the battery contains more than the specified value of mercury (Hg), cadmium (Cd) or lead (Pb) set out in the Batteries and Accumulators Regulation.

The solid bar indicates that the product was placed on the market after 13th August, 2005.

Please dispose of your product and batteries responsibly.

In the UK, give this toy a second life by disposing of it at a small electricals collection point* so all of its materials can be recycled.

Learn more at:

www.vtech.co.uk/recycle

www.vtech.com.au/sustainability

* Visit www.recyclenow.com to see a list of collection points near you.

CARE & MAINTENANCE

1. Keep the vehicle clean by wiping them with a slightly damp cloth.
2. Keep the vehicle out of direct sunlight and away from any direct heat sources.
3. Remove the batteries if the vehicle will not be in use for an extended period of time.
4. Do not drop the vehicle on hard surfaces and do not expose the vehicle to moisture or water.

TROUBLESHOOTING

If for some reason the vehicle stops working or malfunctions, please follow these steps:

1. Turn the vehicle **Off**.
2. Interrupt the power supply by removing both batteries.
3. Let the vehicle stand for a few minutes, then put back the batteries.
4. Turn the vehicle **On**. The vehicle should now be ready to use again.
5. If the vehicle still does not work, install a new set of batteries.

CONSUMER SERVICES

Creating and developing **VTech®** products is accompanied by a responsibility that we at **VTech®** take very seriously. We make every effort to ensure the accuracy of the information, which forms the value of our products. However, errors sometimes can occur. It is important for you to know that we stand behind our products and encourage you to call our Consumer Services Department with any problems and/or suggestions that you might have. A service representative will be happy to help you.

UK Customers:

Phone: 0330 678 0149 (from UK) or +44 330 678 0149 (outside UK)

Website: www.vtech.co.uk/support

Australian Customers:

Phone: 1800 862 155

Website: support.vtech.com.au

NZ Customers:

Phone: 0800 400 785

Website: support.vtech.com.au

PRODUCT WARRANTY/ CONSUMER GUARANTEES

UK Customers:

Read our complete warranty policy online at vtech.co.uk/warranty.

Australian Customers:

VTECH ELECTRONICS (AUSTRALIA) PTY LIMITED –
CONSUMER GUARANTEES

Under the Australian Consumer Law, a number of consumer guarantees apply to goods and services supplied by VTech Electronics (Australia) Pty Limited. Please refer to vtech.com.au/consumerguarantees for further information.

**Visit our website for more
information about our products,
downloads, resources and more.**

www.vtech.co.uk
www.vtech.com.au

